

1

2

3

4

5

A

B

C

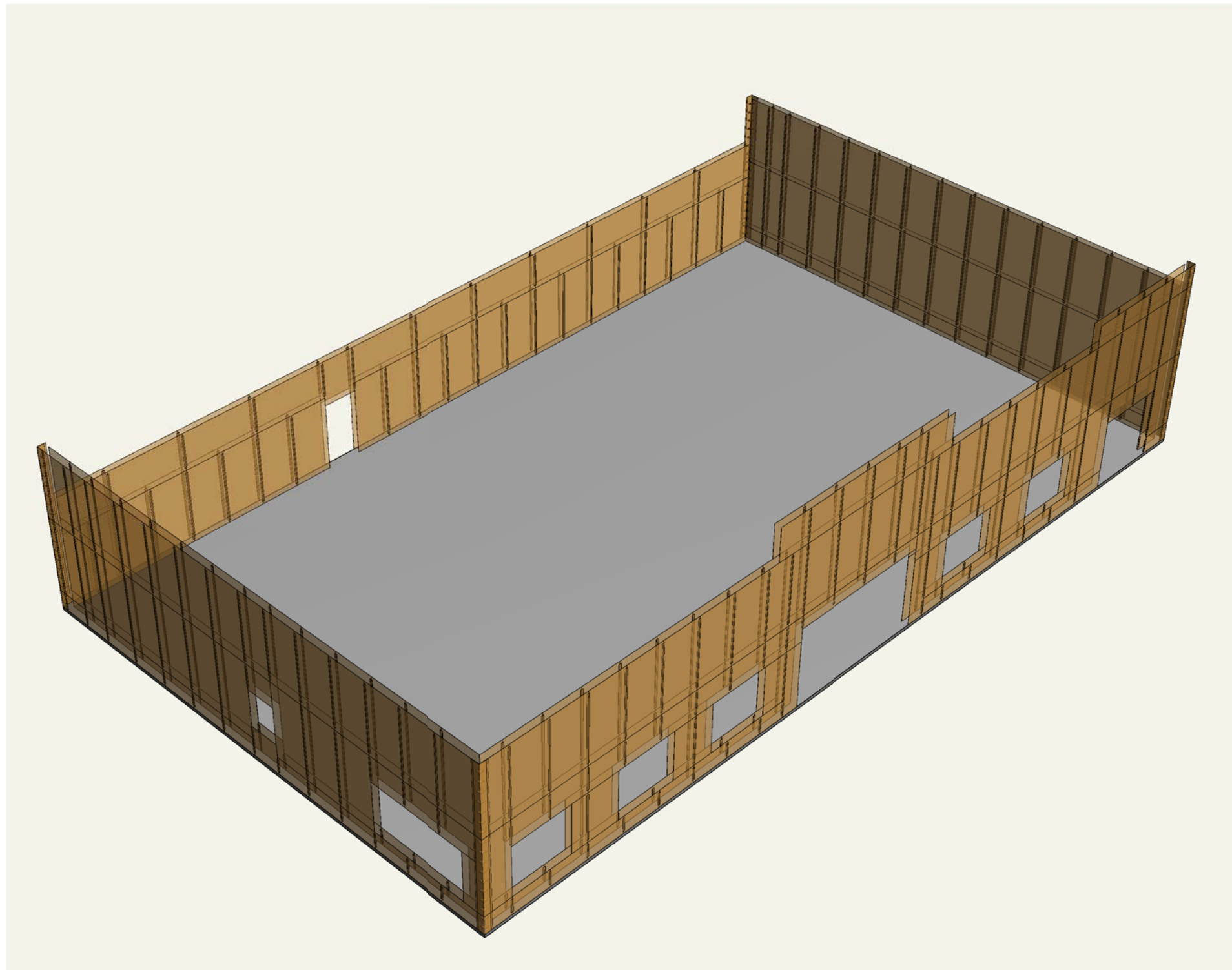

1 3D VIEW 1
 FULL SCALE: 0 12

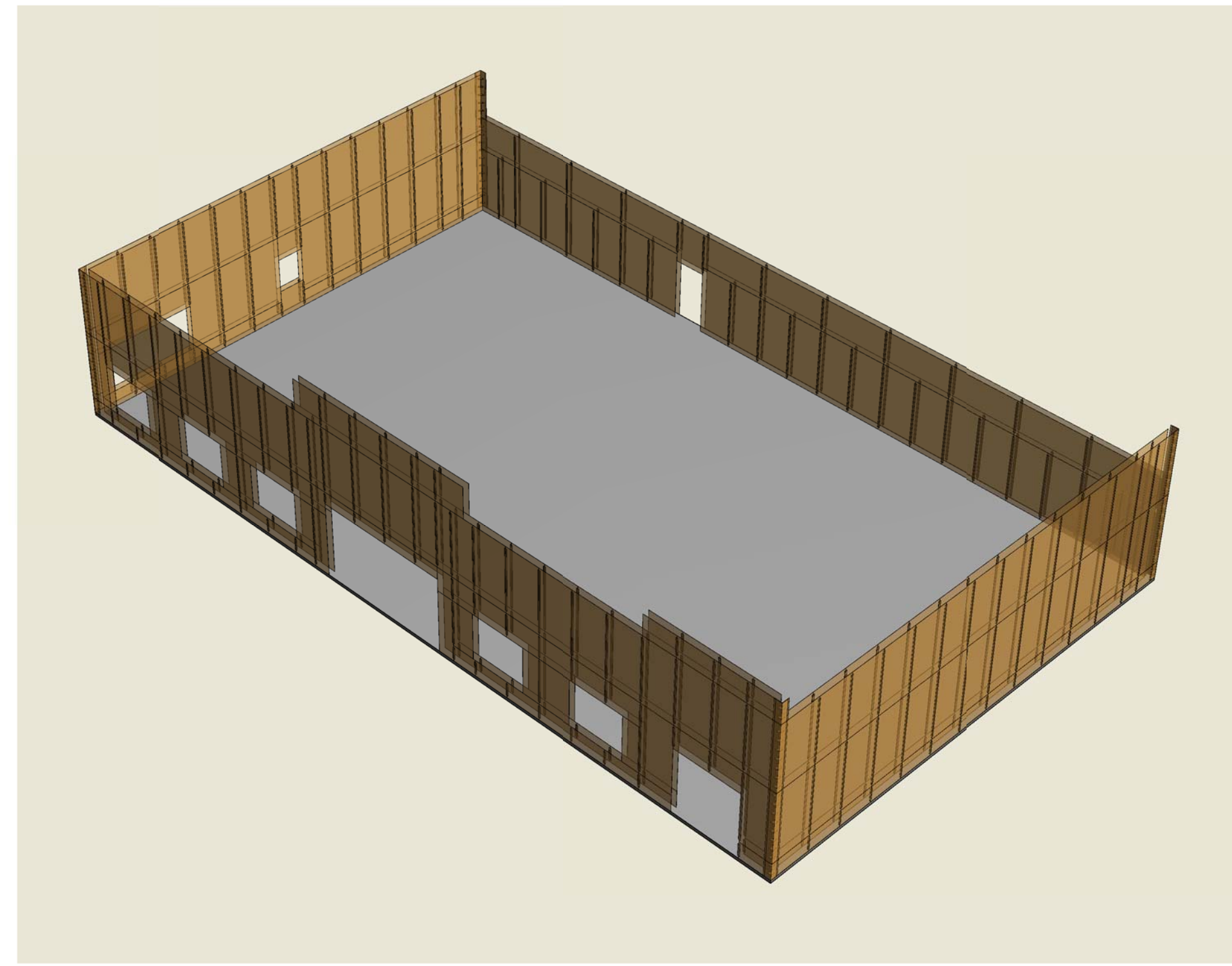

2 3D VIEW 2
 FULL SCALE: 0 12

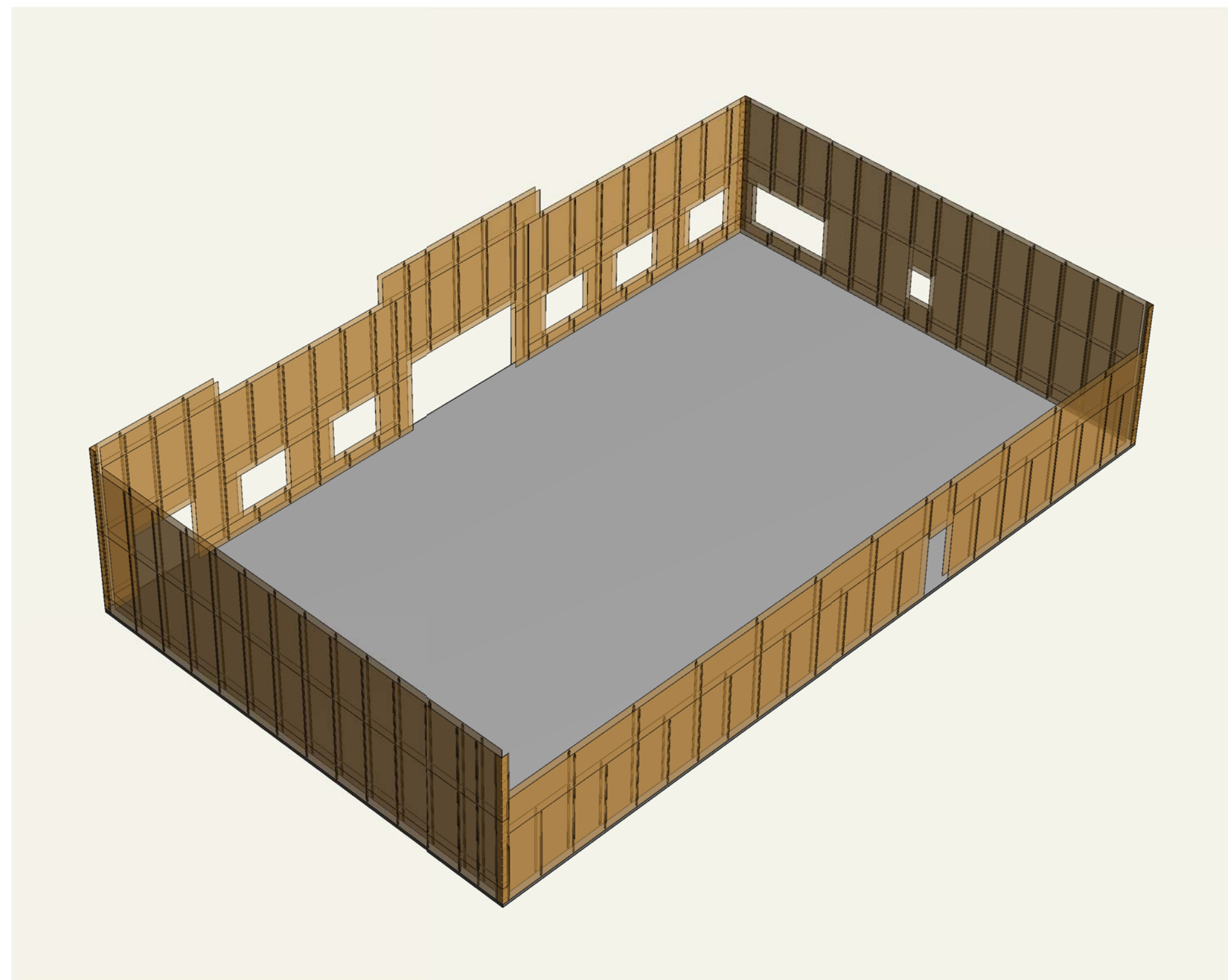

3 3D VIEW 3
 FULL SCALE: 0 12

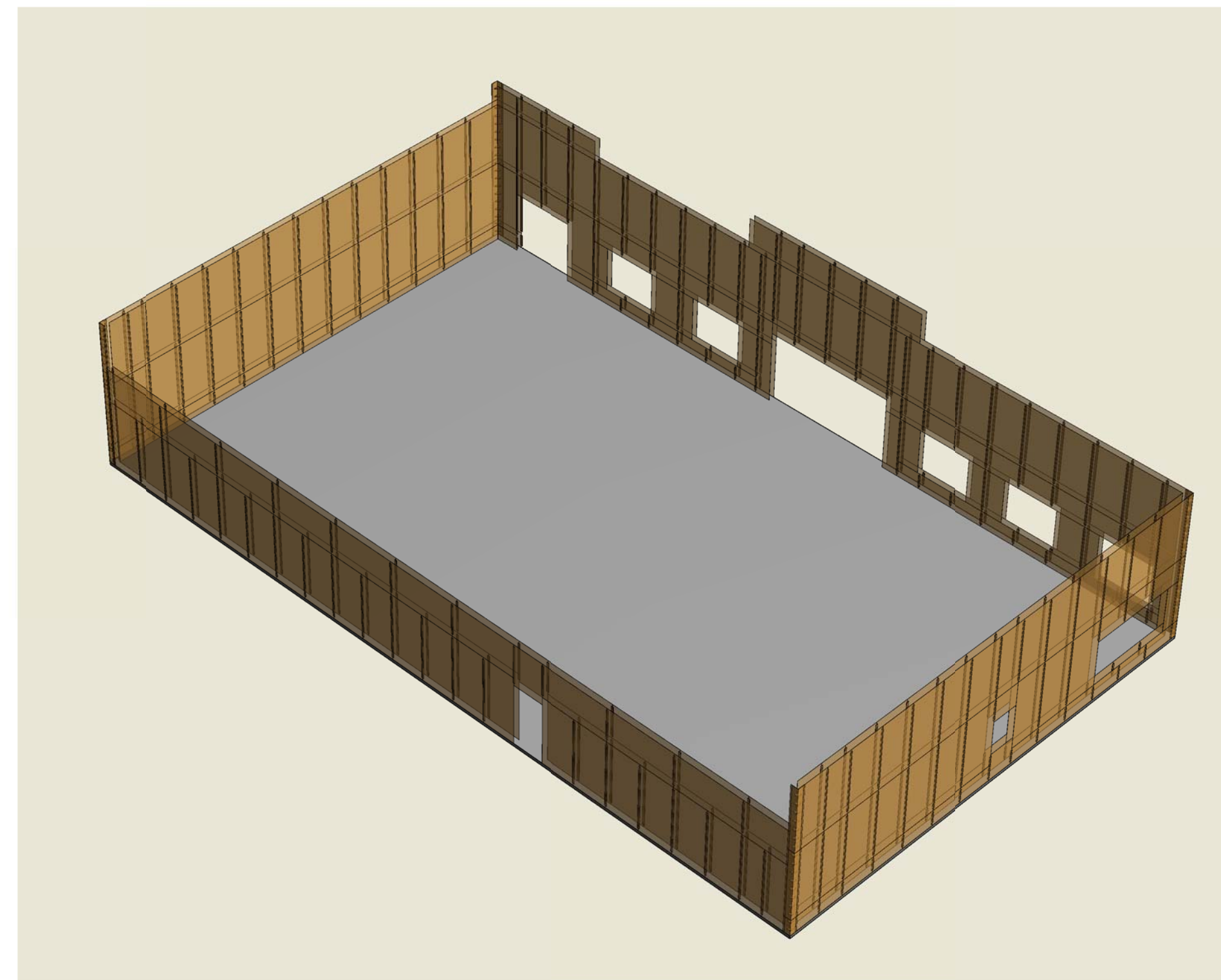

4 3D VIEW 4
 FULL SCALE: 0 12

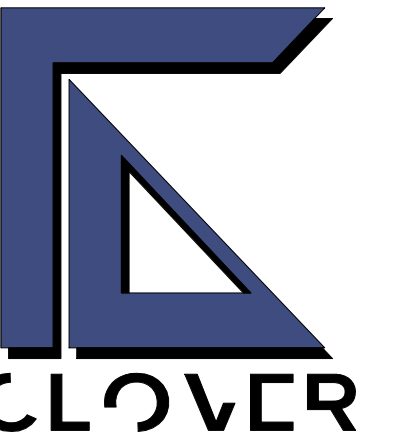

CLOVER-CSE LLC
 PO BOX 2165
 PEACHTREE CITY, GA 30269
 COSHEA@CLOVER-CSE.COM
 (850) 750-1987

SEAL

INFO

OWNER AND/OR CONTRACTOR IS RESPONSIBLE FOR THE CONSTRUCTION PHASE OF THIS PROJECT AND SHALL FOLLOW ALL LOCAL AND NATIONAL BUILDING CODES AS APPLICABLE.

CONSULTANTS

PROJECT NAME

CULLMAN CSTORE

PROJECT LOCATION

N/A

REVISIONS

MARK	DATE	DESCRIPTION

PROJECT NUMBER: 173-00-000
 DESIGNED BY: CLO
 DRAWN BY: JBM
 CHECKED BY: CLO

SHEET TITLE

3D VIEWS

SHEET NUMBER

CW-104